

Front view and mounting

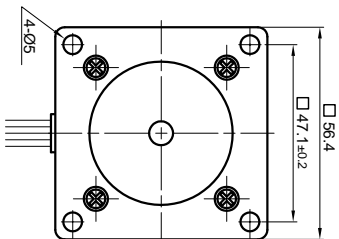

Side view

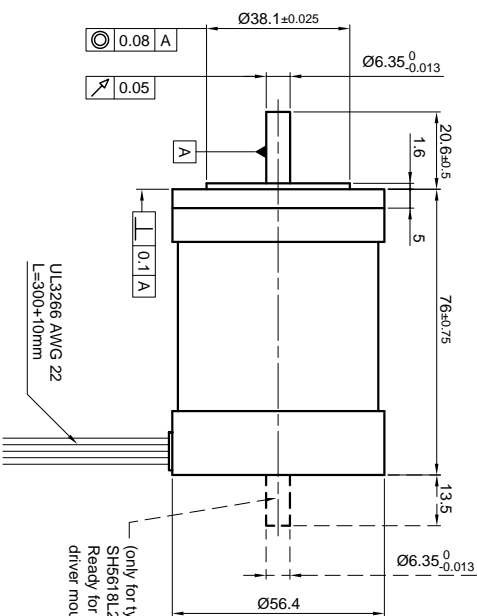

Rear view

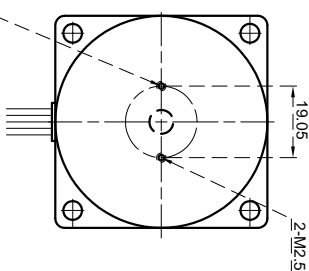

SPECIFICATION	CONNECTION	
	UNIPOLAR OR BIPOLAR-1 WINDING	BIPOLAR
VOLTAGE (VDC)	4.2	5.87
AMPS/PHASE	2.3	1.63
RESISTANCE/PHASE (Ohms)@25°C	1.8±15%	3.6±15%
INDUCTANCE/PHASE (mH) @1KHz	4.1±20%	16.4±20%
HOLDING TORQUE (Nm) [lb-in]	1.05 [9.292]	1.48 [13.1]
DETTENT TORQUE (Nm) [lb-in]	0.0315 [0.279]	1.48 [13.1]
STEP ANGLE (°)	1.8	1.8
STEP ACCURACY (NON-ACCUM)		±5%
ROTOR INERTIA (kg-m ²) [lb-in ²]	2.30x10 ⁻⁵ [0.079]	0.85 [1.874]
WEIGHT (kg) [lb]		
TEMPERATURE RISE: MAX.80°C (MOTOR STANDSTILL; FOR 2 PHASE ENERGIZED)		
AMBIENT TEMPERATURE -10°~ 50°C [14°F ~ 122°F]		
INSULATION RESISTANCE 100 Mohm (UNDER NORMAL TEMPERATURE AND HUMIDITY)		
INSULATION CLASS B 130° [266°F]		
DIELECTRIC STRENGTH 500VAC FOR 1 MIN. (BETWEEN THE MOTOR COILS AND THE MOTOR CASE)		
AMBIENT HUMIDITY MAX. 85% (NO CONDENSATION)		

PERMISSIBLE RADIAL+AXIAL FORCE

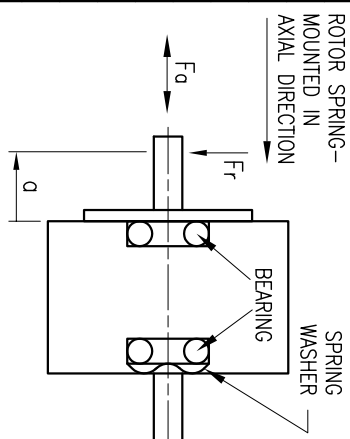

SPECIFICATION	CONNECTION	
	UNIPOLAR OR BIPOLAR-1 WINDING	BIPOLAR
VOLTAGE (VDC)	4.2	5.87
AMPS/PHASE	2.3	1.63
RESISTANCE/PHASE (Ohms)@25°C	1.8±15%	3.6±15%
INDUCTANCE/PHASE (mH) @1KHz	4.1±20%	16.4±20%
HOLDING TORQUE (Nm) [lb-in]	1.05 [9.292]	1.48 [13.1]
DETTENT TORQUE (Nm) [lb-in]	0.0315 [0.279]	1.48 [13.1]
STEP ANGLE (°)	1.8	1.8
STEP ACCURACY (NON-ACCUM)		±5%
ROTOR INERTIA (kg-m ²) [lb-in ²]	2.30x10 ⁻⁵ [0.079]	0.85 [1.874]
WEIGHT (kg) [lb]		
TEMPERATURE RISE: MAX.80°C (MOTOR STANDSTILL; FOR 2 PHASE ENERGIZED)		
AMBIENT TEMPERATURE -10°~ 50°C [14°F ~ 122°F]		
INSULATION RESISTANCE 100 Mohm (UNDER NORMAL TEMPERATURE AND HUMIDITY)		
INSULATION CLASS B 130° [266°F]		
DIELECTRIC STRENGTH 500VAC FOR 1 MIN. (BETWEEN THE MOTOR COILS AND THE MOTOR CASE)		
AMBIENT HUMIDITY MAX. 85% (NO CONDENSATION)		

STEP	TYPE OF CONNECTION (EXTERN)				MOTOR
	UNIPOLAR	BIPOLAR 1WINDING	SERIAL	PARALLEL	
A	—	A	A	A	RED
COM	—	—	—	—	RED/WHT
A \	—	A \	A \	A \	BLK/WHT
B	—	B	B	B	BLK
COM	—	—	—	—	GRN
B \	—	B \	B \	B \	GRN/WHT
					YEL/WHT
					YEL

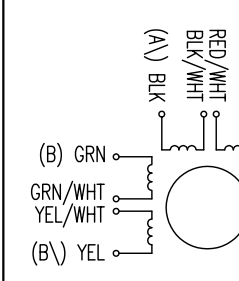

NANOTEC:

SH5618L2308

REV	DESCRIPTION	DATE	APVD

SCALE	FREE	APVD	S.K.K.
X	±0.5	CHKD	
1PL	±0.2	DRN	J.W.
2PL	±0.1	SIGNATURE	
ANGLE	±30°	DATE	

DATE	DATE	DWG.NO
13.07.06	13.07.06	SH5618L2308

STEPPING MOTOR